

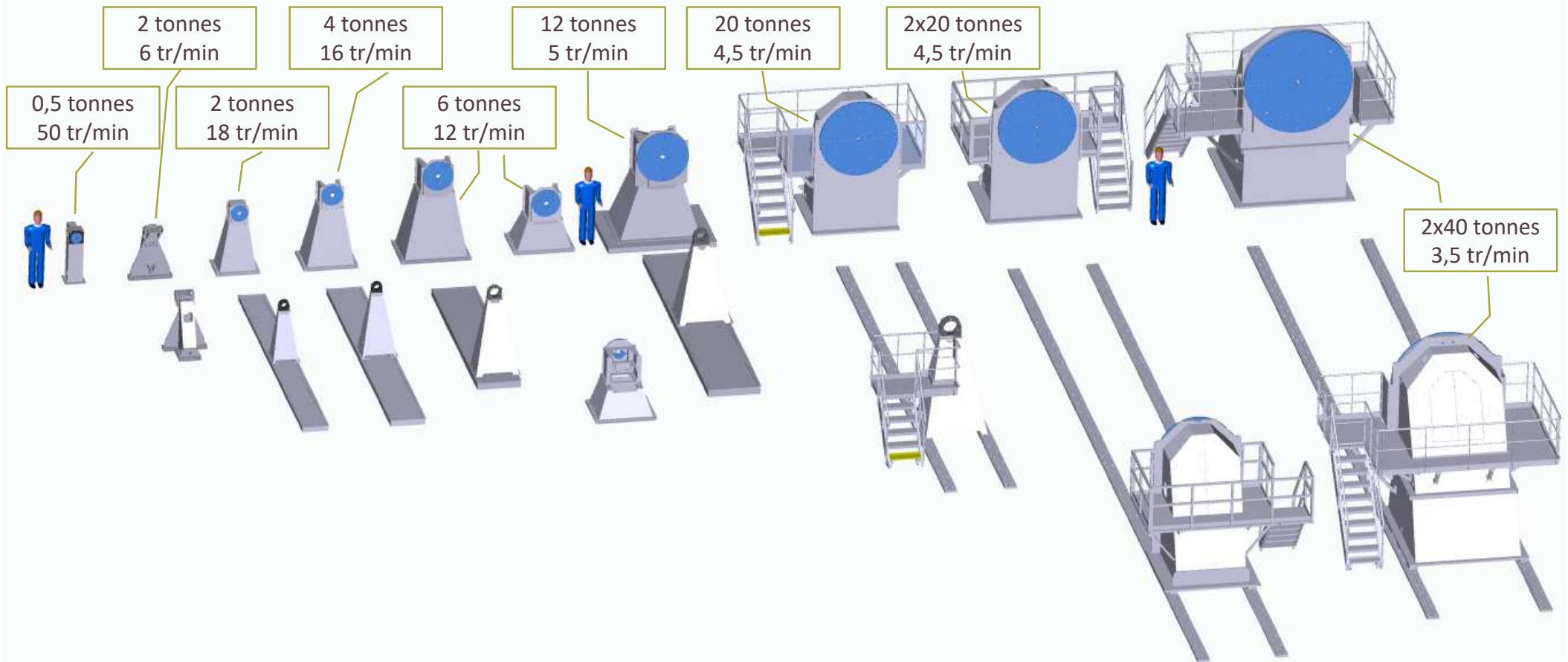

SUD OUEST SYSTEME
machines outils

Horizontal positioners





SUD OUEST SYSTEME
machines outils

Vertical positioners

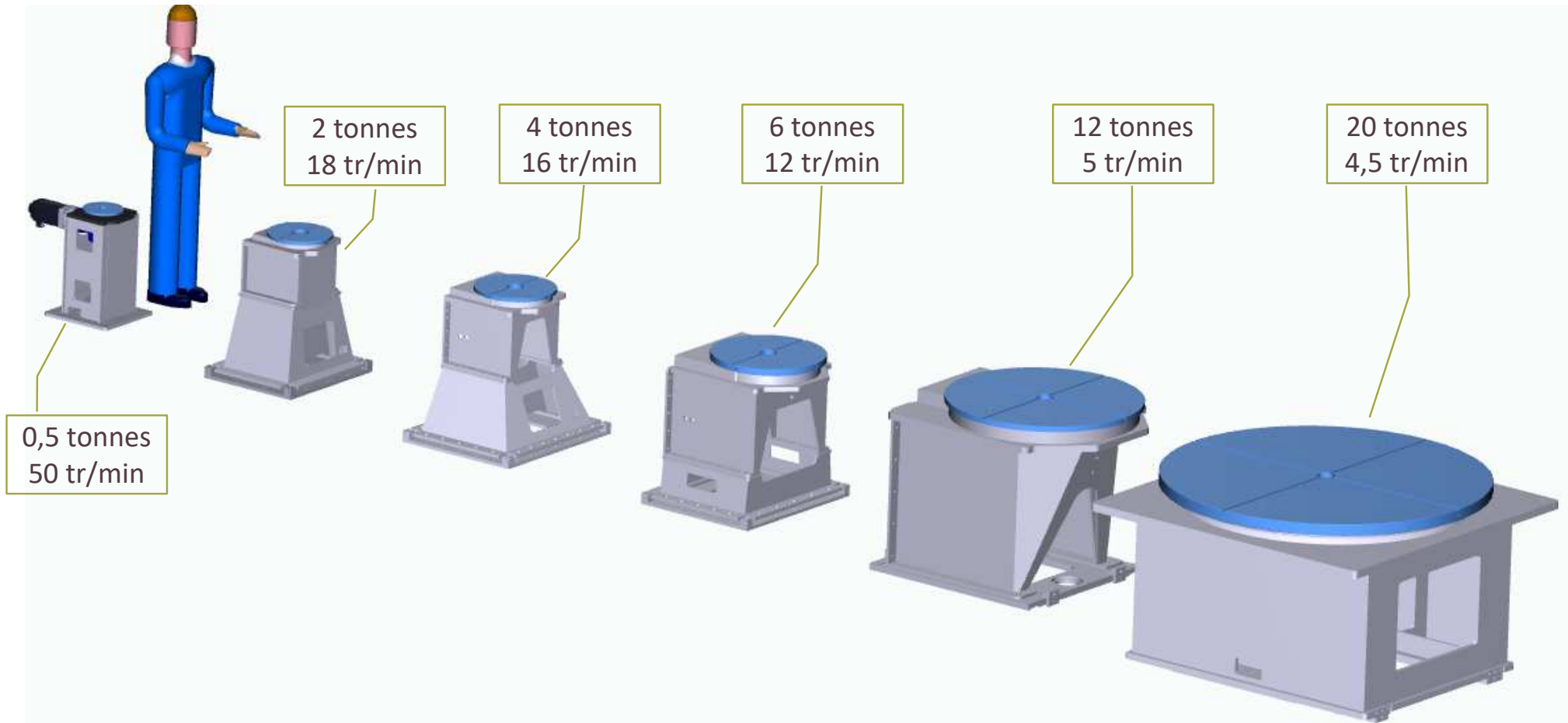



Continuous

Positioner

Continuous positioner 3T :



Features :

- Rotation speed : 6 tr/min.
- Acceleration : $90^\circ/s^2$.
- Maximum inertia : 800 kg/m^2 .
- Nominal torque : 1 750 N/m.
- Axis / ground height : 1 100 mm.
- Accuracy : 0,20 mm/m.

Continuous positioner 6T :



Features :

- Rotation speed : 16 tr/min.
- Acceleration : $180^\circ/s^2$.
- Maximum inertia : $5\,500 \text{ kg/m}^2$.
- Nominal torque : 5 750 N/m.
- Axis / ground height : 2 010 mm.
- Accuracy : 0,20 mm/m.

Continuous positioner 12T with 5 m bench :

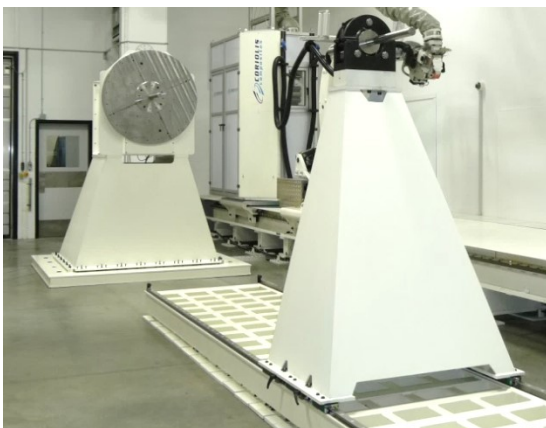

Features :

- Rotation speed : 5 tr/min.
- Acceleration : $45^\circ/s^2$.
- Maximum inertia : $12\,000 \text{ kg/m}^2$.
- Nominal torque : 11 000 N/m.
- Axis / ground height : 2100 mm.
- Between positioner : 3 to 8 m.
- Accuracy : 0,20 mm/m.



Continuous

Positioner

Continuous positioner 12T Elevator :



Features :

- Rotation speed : 4 tr/min.
- Acceleration : $40^{\circ}/s^2$.
- Maximum inertia : 18 000 kg/m².
- Nominal torque : 40 000 N/m.
- Axis / ground height : 4300 mm.
- Vertical displacement : 3000 mm.
- Feed rate : 3 m/min.
- Accuracy : 0,20 mm/m.

Continuous positioner 20T :

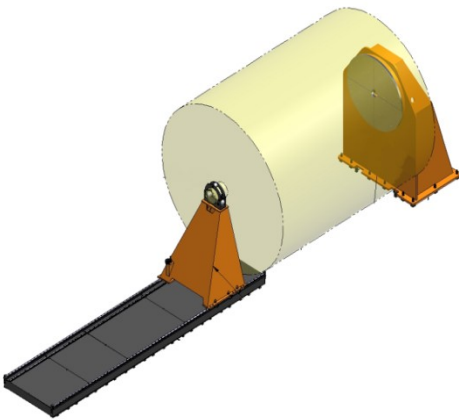

Features :

- Rotation speed : 4 tr/min.
- Acceleration : $36^{\circ}/s^2$.
- Maximum inertia : 33 000 kg/m².
- Nominal torque : 19 000 N/m.
- Axis / ground height : 2 400 mm.
- Accuracy : 0,20 mm/m.

Accuracy linear bench :



Features :

- Displacement speed : 90 m/min.
- Acceleration : $1,5m/s^2$.
- On-board mass : 800 kg/m².
- Stroke : from 6 up to 28 m.
- Accuracy : 0,2 mm on the stroke.
- Maximum deviation : 0,07 mm/m.